

KS 120

1/2" CCD B/W Video Camera



- **1/2" CCD Sensor**
- **440,000 pixel**
- **Automatic and Manual Electronic Shutter**
- **CS Mount | C Mount**
- **Small dimension**
34 (H) x 34 (W) x 60 (D) mm

Technical Data

Type

KS 120

TV system

CCIR

CCD type

1/2" CCD 752 (H) x 582 (V)

Total pixel

2:1 interlaced

Scanning Lines

625 Lines

Sync System

Ext. HD/VD auto switch

Resolution

Min 560 TV lines

Scanning frequency (horiz.)

15.625 KHz

Scanning frequency (Vert.)

50Hz

Aspect ratio

4:3

Illumination (1/2" CCD)

Minimum: 0.5Lux, F1.4 (AGC ON), approx. 50% Video level

Video output

1V p-p Composite Video

Signal/noise ratio (SNR)

>50 dBp-p/rms

Electronic Shutter

Auto / Manual selectable

Maximum shutter speed 1/100,000 sec.

Manual Shutter

8 steps up to 1/10,000

Gamma

0.45/1.0 switchable internal

Automatic Gain Control (AGC)

ON/OFF 0~18dB adjustable

Power supply

DC12V +/- 10%

Power consumption

Max. 160 mA

Environmental condition

Temperature: 0° to 50°C

Humidity: max. 95%

Lens type

CS / C-Mount

External dimension

34 (W) x 34 (H) x 60 (D)mm

Weight

approx. 100 g

Dimension

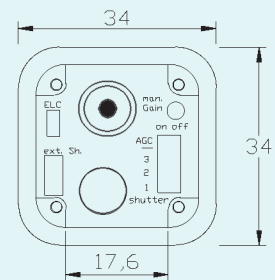
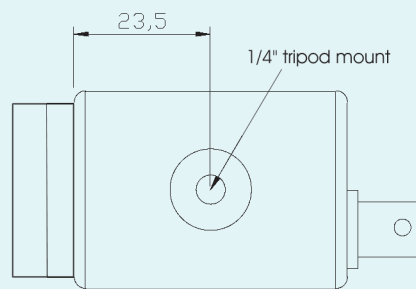
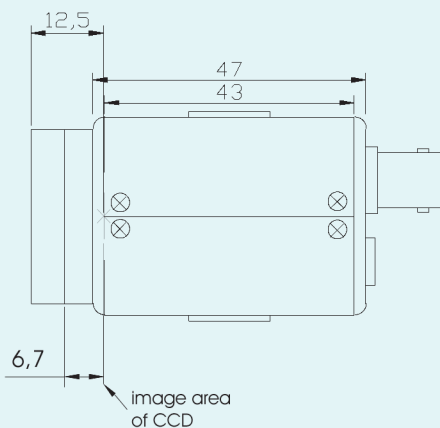

NEW ELECTRONIC TECHNOLOGY Vertriebs-GmbH

Lerchenberg 7 • D 86923 Finning, Germany • Phone: +49(0)88 06 - 92 34-0 • Fax: +49(0)88 06 - 92 34-77

E-mail: info@net-gmbh.com

NET USA, Inc.

3037-45th Street #8 • Highland, IN 46322 • Phone: (219) 934-9042 • Fax: (219) 934-9047

E-mail: netusa@bellsouth.net

www.net-gmbh.com